

## INSTALLATION PROCESS:

### A Basic Installation of FK003D306-3 Front 1995-1997 BMW R850 R

Torque specifications  
Stainless steel 15-17 ft. lbs  
Aluminum 12-15 ft. lbs



#### Step 1:

Identify the key components that complete our brake line kit:

You should have three (3) brake lines and three (3) single banjo bolts. We have also included a total of eight (8) washers; six (6) will be used, and two (2) will be spares. We strongly suggest having a professional mechanic install your brake lines, all other installs may void your warranty.

#### Step 2:

To ensure there is no paint damage from the brake fluid, completely cover the front end of the bike. Installing brake lines can be a messy process, and brake fluid *WILL* spill!

#### Step 3:

After bleeding and drying out the OEM brake system, uninstall your front stock hoses. Take note of how the stock system was routed in case you need to re-install the hoses.

#### Step 4:

Familiarize yourself with the new Galfer brake lines; notice there is a right (**B**) and left (**C**) line, this is as if you are sitting on the bike, as well as a “top” or master cylinder (**A**) line. Install the top line to the front master cylinder using a single banjo bolt and two (2) washers, the sequence will be as follows; master cylinder, washer, banjo fitting, washer, single banjo bolt (**see line A.**)

#### Step 5:

Route the “top” master cylinder line down towards stock mounting point on the lower triple tree. Route the right line (**B**) down through the stock line holder and to the appropriate caliper. Install the line using a single banjo bolt and two (2) washers, the sequence will be the same as before. Route the left (**C**) line across to the left side, through the stock line holders and down to the appropriate caliper. Install the left line to the caliper using a single banjo bolt and two (2) washers, the sequence will be the same as before (**see lines B & C.**)

#### Step 6:

Before you begin the next step, please check the clearance of your new lines. When the front end is fully extended or compressed, make sure the lines do not bind with anything. Be sure to triple check that the lines are traveling correctly and are clear from any obstructions.

#### Step 7:

Bleed your brake system according to the owner’s manual. Add Galfer DOT-4 brake fluid to the system and build appropriate pressure.

#### Step 8:

Once you have bled the system, please check the brake fluid level in your master cylinder. Top off your brake fluid according to your manual and close the brake fluid reservoir. To ensure there are no leaks or other issues, zip-tie the brake lever to the throttle for at least 2 hours. If the line(s) are not leaking and all else looks good, (bolts are tight and torqued down to specification, washers are in place, and lines are clear from obstruction) you are now ready to ride with the new brake system.

Please be aware that the overall braking feel has been changed dramatically. We suggest taking it easy while you get used to the new brake lever pressure and feel. We recommend checking your brake system periodically; be sure to check that your bolts are tight and *VERY* carefully check your lines for any leaks or damage. If there are any signs of damage or stress to the lines, the complete brake line kit will need to be replaced. Remember, our brake lines have a **LIFETIME WARRANTY!** If you have any problems or questions, do not hesitate to call our tech department - **(800) 685-6633**.

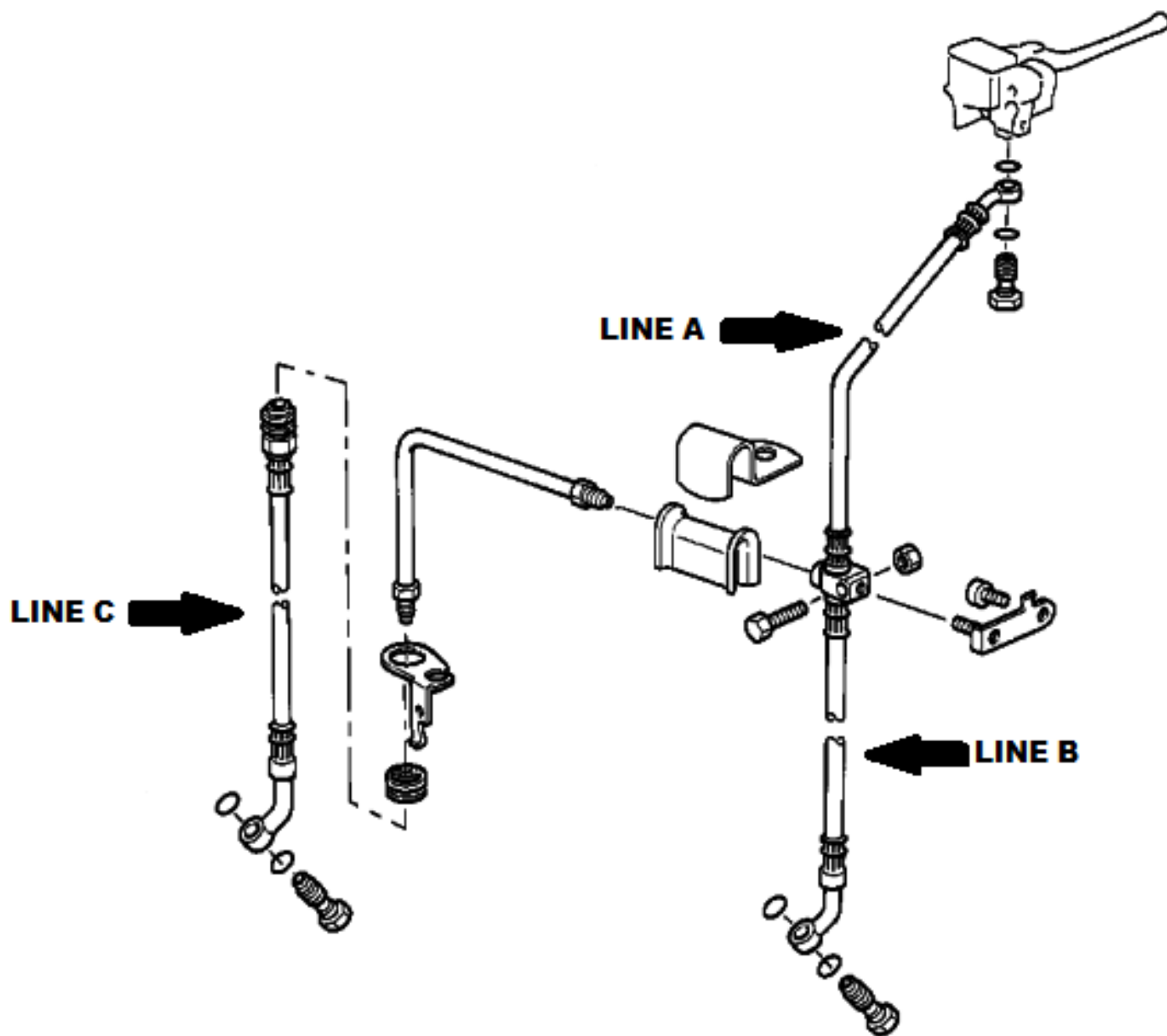

**GALFER USA**  
310 IRVING DRIVE  
OXNARD, CA 93030  
PH (805) 988-2900 . FAX (805) 988-2948  
[WWW.GALFERUSA.COM](http://WWW.GALFERUSA.COM)

